

InformaCast

Informacast management documentation

- **Advanced**
 - InformaCast Advanced Users, Groups, and Roles
 - Set Custom IC Advanced Messages
 - Set Custom IC Mobile Msg Template
 - Distribution List to Recipient Group Association
 - InformaCast Emergency Notification Settings
- **Mobile**
 - Add/Edit Users
 - Informacast Mobile User Setup
- **Mobile App**
 - Login to the Mobile App
- **Setup**

Advanced

InformaCast Advanced set up and functions

InformaCast Advanced

Users, Groups, and Roles

InformaCast syncs users and groups from Active Directory. Membership in specific groups sets up permissions in InformaCast Advanced. The following lists Active Directory groups and the associated InformaCast Advanced permissions. Each group will identify InformaCast Advanced Role, Message, and Recipient Group access.

Note: These roles and permissions control what can be accessed when logged into InformaCast Advanced.

InformaCast Users: This group is required for any access in InformaCast Advanced

Roles: schedAdjuster, schedEditor - Allows management of bell schedules

Messages: All Ring Tone messages

Recipient Groups: None

[Building]: These are building identifier groups i.e. Dutton Elementary, Caledonia High, etc.

Roles: None

Messages: Lockdown and Shelter in Place messages for the specific building, Tornado Warning, Basic Paging, Bell Schedules and Ring Lists for the building

Recipient Groups: The building related recipient groups

Principals:

Roles: messageAdmin, messageSender, and schedAdmin

Messages: Clear All Relays

Recipient Groups: None

Administration:

Roles: messageAdmin, messageEditor, and messageSender

Messages: All Lockdowns, Shelter in Place, Tornado Warning, Basic Paging, Clear Relays, and District Radio Alert

Recipient Groups: Admin - All Mobile, Admin - SRO Mobile

Note: Roles and permissions accumulate with membership to multiple groups

Set Custom IC Advanced Messages

Associate InformaCast Mobile Message Templates with InformaCast Advanced Messages. ***When the listed Message Template is sent from InformaCast Mobile, the appropriate Message in InformaCast Advanced will be triggered.***

Caution: To associate an InformaCast Advanced messages with InformaCast Mobile Message Templates, the Advanced message must be set to "**Allow users to customize message at send time**".

Set Advanced Message to "Allow users to customize message at send time"

To verify/change this setting:

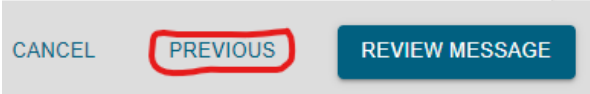
- Select the message in InformaCast Advanced
- Click on the **PREVIOUS** button in the lower right
- 
- Check the "**Allow users to customize the message at send time**" checkbox
- Let's set up some options for your message. Would you like to:
 - ☒ Allow users to customize the message at send time
 - ☐ Re-broadcast the message
 - ☐ Require message confirmation
- To save the change
 - Click on the **COMPOSE MESSAGE** button in the lower right
 - Click on the **REVIEW MESSAGE** button in the lower right
 - Click on the **SAVE** button in the lower right

The InformaCast Advanced message will now be available in the Set Custom InformaCast Advanced Messages setup

Associate Advanced Message with Mobile Template

To associate an InformaCast Advanced message with with an InformaCast Mobile message template:

- Login to InformaCast Advanced
- Select **Endpoints** from the left menu
- Select the **InformaCast Mobile** tile
- Expand the **Set Custom InformaCast Advanced Messages** section
- Click on the InformaCast Mobile message template
- Select the InformaCast Advanced message to associate with from the message dropdown

Note: You may need to type a few characters of the message name for it to appear in the dropdown.

- Click on the **SAVE** button to save the association

Set Custom IC Mobile Msg Template

Associate InformaCast Advanced Messages with InformaCast Mobile Message Templates. ***When the listed Message is sent from InformaCast Advanced, the appropriate Message Template in InformaCast Mobile will be triggered.***

To Associate IC Mobile Template with IC Advanced Message

- Login to InformaCast Advanced
- Select **Endpoints** from the left menu
- Select the **InformaCast Mobile** box
- Expand the **Set Custom InformaCast Mobile Message Templates** section
- Select the **InformaCast Advanced Message** to associate with an **InformaCast Mobile Message Template**
- Select the InformaCast Mobile Message Template from the **Message Template** dropdown

Note: You may need to type a few characters of the message name for it to appear in the dropdown.

- Click on the **SAVE** button to save the association

Warning: For an InformaCast Advanced Recipient Group to get passed to an InformaCast Mobile Message Template, the Distribution List on the InformaCast Mobile Message Template cannot be locked.

To Verify/Unlock an IC Mobile Message Template Distribution List

- Login to InformaCast Mobile
- Select **Message Templates** from the Quick Links menu or under Notifications from the main menu
- Select the Message Template from the list
- Scroll down to the **Recipient** section
- Distribution Lists must be enabled (green check)

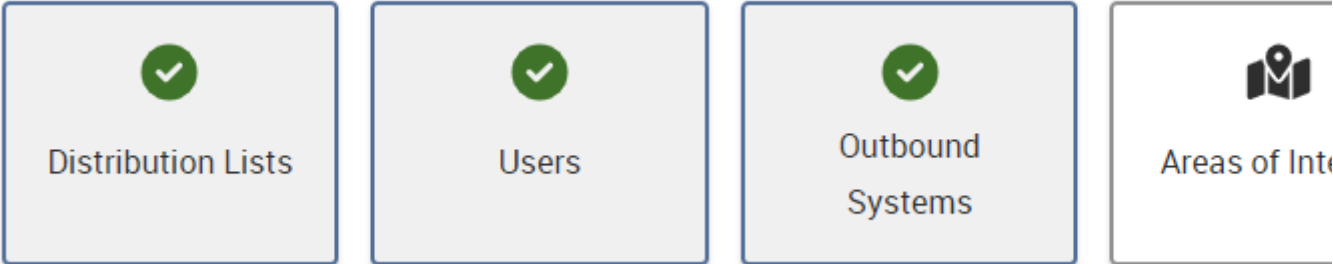
- 

- The Distribution Lists dropdown must be **unlocked**

- **Distribution Lists**



- If changes were made click on the **Save Template** button in the lower right

The Message Template will now accept Recipient Groups from Informacast Advanced messages

Distribution List to Recipient Group Association

Associate InformaCast Mobile Distribution Lists with InformaCast Advanced Recipient Groups.

For InformaCast Mobile to send messages to InformaCast Advanced Recipient Groups an association must be made between the InformaCast Mobile Distribution List and one or more InformaCast Advanced Recipient Group(s).

Warning: For an InformaCast Mobile Distribution List to be associated with InformaCast Advanced Recipient Group(s), The InformaCast Mobile Distribution List must have ~System InformaCast set as a User and InformaCast Plugin set as an Application.

To setup an IC Mobile Distribution List to be Associated with a Recipient Group

- Login to InformaCast Mobile
- Select **Distribution Lists** from the Quick Links menu or under Recipients from the main menu
- Select the InformaCast Mobile Distribution List you want to associate with an Informacast Advanced Recipient Group
- Under the Users tab click on the plus sign (+) to the right to add a user
- Click on the plus sign (+) to the right of ~System InformaCast from the list of users.

Note: The user row should be highlighted in yellow

- Click on the Done button in the lower left
- ~System InformaCast will now be listed as a user
- Select the Applications tab
- Click on the plus sign (+) to the right to add an application
- Click on the plus sign (+) to the right of the InformaCast Plugin application

Note: The row should be highlighted in yellow

- Click on the Done button in the lower left
- InformaCast Plugin will now be listed as an application
- Click on the Save button in the upper right to save the distribution list

The Distribution List will now be available in InformaCast Advanced for association with Recipient Groups.

Associate IC Mobile Distribution List to IC Advanced Recipient Group

- Login to InformaCast Advanced
- Select **Endpoints** from the left menu
- Select the **InformaCast Mobile** tile
- Expand the **InformaCast Mobile Distribution List to Recipient Group Association** section
- Select the InformaCast Mobile Distribution List from the left column
- Add one or more Recipient Groups to the dropdown

Hint: Type a few letter of the Recipient Group name to filter the list

- Click on the **SAVE** button to save the association

The selected Recipient Groups are now associated with the InformaCast Mobile Distribution List

InformaCast Emergency Notification Settings

DialCast

Dial phone code in the format: 505#[BLDG NUM]

Message

Alert - [BLDG] Lockdown Message

Recipient Groups

- [BLDG] - Lenel Panel On → Trigger Lenel relay on Barix
- [BLDG] - Fire Panel On → Trigger Fire panel relay on Barix
- [BLDG] - All → Send alert to all building phones and speakers
 - Includes [BLDG] - Mobile → Send alert building administrative staff
- Admin - SRO Mobile → Send alert to district administrative staff and SRO

M2M Contact Closures

Lenel Input triggered on Barix relay

IP Address for Barix relays

Input Ports

[BLDG] Lenel Input - This is triggered from the Lenel panel relay

Message

Alert - [BLDG] Lockdown Message

Recipient Groups

- [BLDG] - Fire Panel On → Trigger Fire panel relay on Barix
- [BLDG] - All → Send alert to all building phones and speakers
 - Includes [BLDG] - Mobile → Send alert building administrative staff
- Admin - SRO Mobile → Send alert to district administrative staff and SRO

Note: Do not include the "Lenel Panel On" relay because that is where the lockdown originated

Configure Output Ports for various relays

- Relay 1 - Always Lenel Panel
- Relay 2 - Always Fire Panel
- Relay 3 - Available
- Relay 4 - Available

A Barix relay might be setup just to control other devices like security curtains and not need a Lenel or Fire Panel configured.

Mobile

Information on InformaCast Mobile

Add/Edit Users

Administrative staff and school security staff are set up in InformaCast Mobile in order to receive mobile notifications

Log in to Informacast Mobile

<https://admin.icmobile.singlewire.com/icmobile/#/home>

Use your Caledonia Google account for Single Sign On

Select Users from the Quick Links menu

Click on Create User to add anew user or Edit next to an existing user to edit that user

Basic Information

- Name
- Email

Registered Devices and Locations

- Add User Device
 - SMS
 - Phone Call
 - Email
- Check the Verify checkbox

Communication Preferences

- Subscribe to appropriate Distribution Lists

Informacast Mobile User Setup

Informacast mobile is used by administrative staff and other special purpose recipients. We are licensed for 50 Informacast mobile users.

Login - Log in at: <https://admin.icmobile.singlewire.com/icmobile/#/login>

Use your CalSchools email address for Google SSO

Add User

- Users
- Click on Create User in upper right to add a new users

Basic Information

- Name (First & Last)
- Email
 - Check Create an Email Device
 - Check Verify Email Device
 - Save

Under Registered Devices and Locations

- Add User Device
 - Device Type: SMS
 - Phone Number: District cell phone number
 - Name: Mobile
 - Enabled
 - Save
 - Verify Device Immediately: Check Verify Device
 - OK

Add additional mobile numbers for SMS, phone number for voice calls, and additional email addresses

Communication Preferences

Subscribe to Distribution List

- Add Mobile group membership based on position
 - Mobile-Admin All
 - Mobile-[BLDG]

Note: The members of these groups get notifications for different situations

Security Tab

Security Information

Enter lockdown notifications the user can initiate by selecting Security Group

- Assign to Security Group
- [BLDG]-Lockdown
- Save

Mobile App

Login to the Mobile App

You login to the mobile app with SSO using your Caledonia Google Workspace credentials

Open the Informacast mobile app and tap on the Log In button

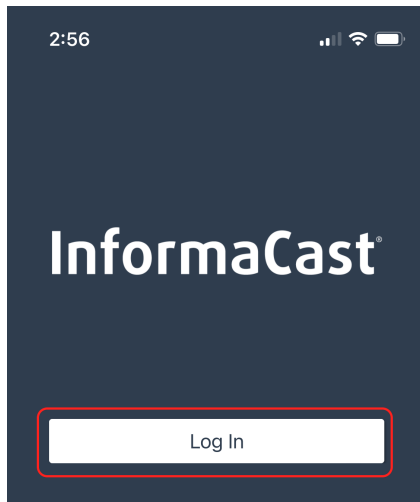

Enter your Caledonia Google Workspace email address and tap on the red continue button

Note: You might need to select the correct Google account and enter your password

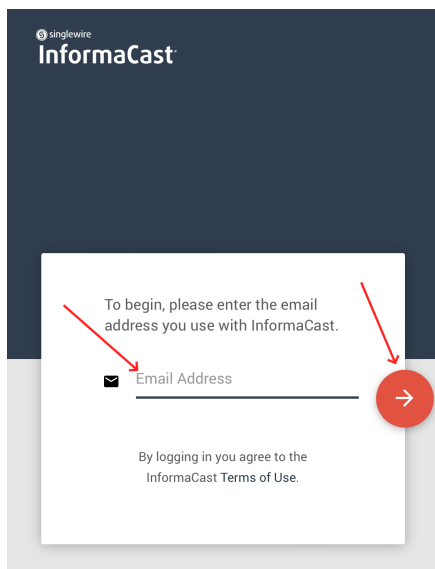

Setup

Information on setting up InformaCast Advanced and Mobile associations.